

SAFETY MOUNTING INSTRUCTIONS

Mounting disc should be carried out according to instructions provided by both disc and machine manufacturer. Make sure flanges are flat and clean. Always use suitable flanges. Flanges must have the same diameter and same shape towards both faces of the disc. (Exception to the Raised Hub Flanges, Box [1]).

180-230mm / 7"-9" Mounting

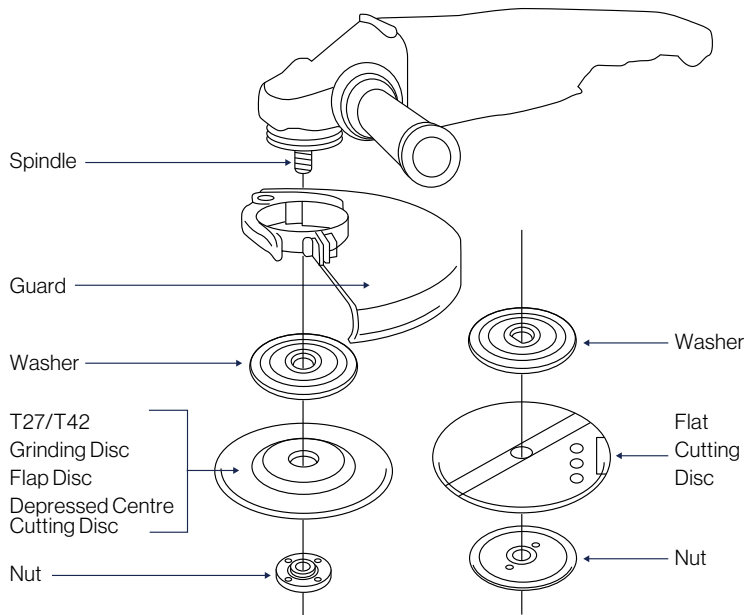

[1] Grinding and Flap Disc T27
Depressed Centre Cuttin T42

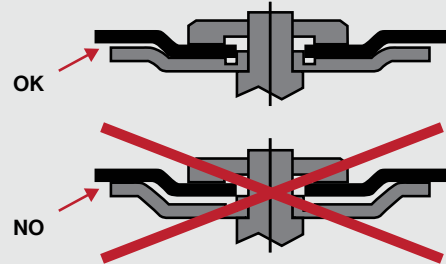

[2] Flat Cutting Dis T41

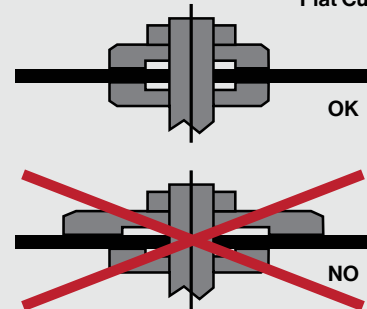

100-125mm / 4"-5" Mounting

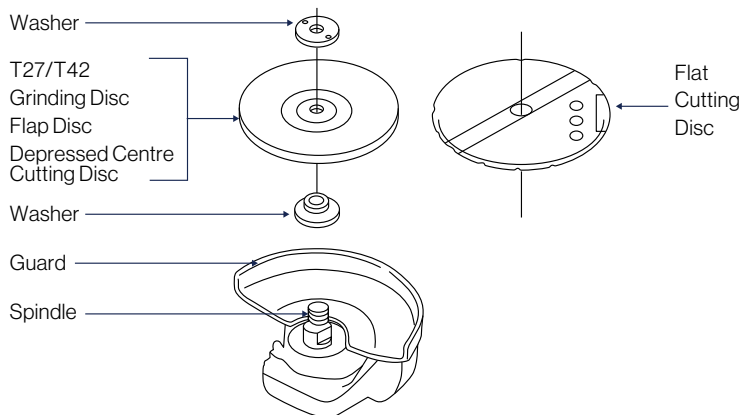

[3] Grinding and Flap Disc T27
Depressed Centre Cuttir T42

